

V-Series



Plastic Submersible Pumps
V4P

50 Hz



Evak Pump Technology Corp.
No. 551, Zhongshan Rd., Qingshui Dist,
Taichung City 436, Taiwan.
Tel : +886-426-235556
Fax : +886-426-235559
www.evak-pumps.com



Pumps & Pumps

V-Series

Index / Plastic Submersible Pumps VP-Series

Index/Type Key—02	
General Data—03	
V4P-05—05	V4P-35—10
V4P-10—06	V4P-40—11
V4P-13—07	V4P-55—12
V4P-18—08	V4P-60—13
V4P-25—09	V4P-80—14

Type Key

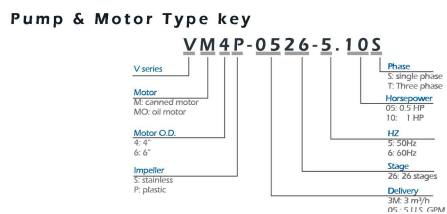
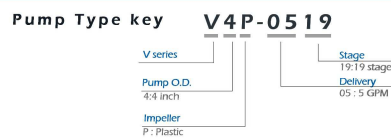

EVAK V-Series 4" Plastic Submersible Deep Well Pumps



Evak's 4" VP series of pumps are manufactured using high quality material, and are designed to deliver years of reliable service. Pumps are on the floating impeller design which reduces starting torque requirements and decreases the effects of sand in the water.

Pumped Liquids:
Clean, non-corrosive and non-abrasive liquids

Operating Conditions:
Max. Liquid temperature: 60°C
Sand content: Max. 50 g/m³

Feature

- > The discharge has a built-in check valve
- > The pump body is covered by a 304 polished stainless steel shell
- > The shafts are made from hex 304 stainless steel bar material
- > Impellers are floating type (Noryl)

Application

- > Potable water supply from deep wells
- > Agricultural-Irrigation, livestock watering
- > Municipal and industrial
- > Pressure boosting
- > Fountains, etc

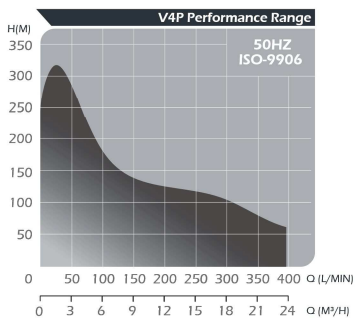
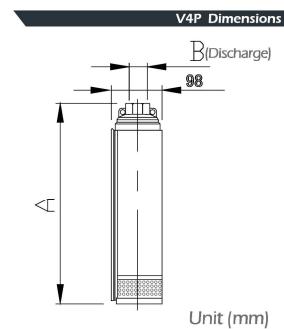

\ V4P-05~25

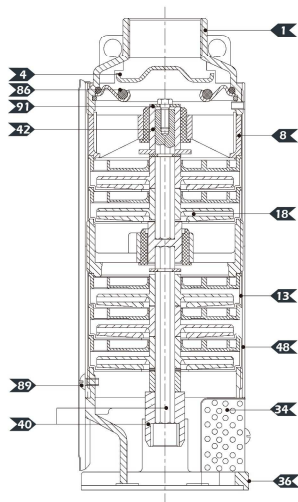

No.	Part	Material
1	Discharge	SUS304
4	Valve Cone	SUS304
8	Upper Bearing Spider	Glass/Polycarbonate
13	Body	SUS304
18	Impeller	Noryl
34	Strainer	SUS304
36	Suction Interconnector	SUS304
40	Pump Shaft / Coupling	SUS304
42	Upper Shaft Sleeve	SUS304
48	Casing	SUS304
86	O-ring	NBR
89	Screw	SUS304
91	Washer	SUS304

All technical information is subject to change without notice.

V4P-05 Dimensions and Weight

Type	A	B	Weight(kg)
V4P-0513	377	1 1/4"	3.7
V4P-0526	642		5.8

V4P-10 Dimensions and Weight

Type	A	B	Weight(kg)
V4P-1005	234	1 1/4"	2.5
V4P-1007	271		2.8
V4P-1010	324		3.3
V4P-1014	394		3.9
V4P-1020	499		4.9
V4P-1028	680		6.9
V4P-1040	885		9.3

V4P-13 Dimensions and Weight

Type	A	B	Weight(kg)
V4P-1305	236	1 1/4"	2.5
V4P-1308	289		2.9
V4P-1311	342		3.4
V4P-1316	430		4.2
V4P-1321	519		5.0
V4P-1332	749		7.1

V4P-18 Dimensions and Weight

Type	A	B	Weight(kg)
V4P-1805	257	1 1/4"	2.7
V4P-1807	301		3.0
V4P-1809	344		3.3
V4P-1814	452		4.1
V4P-1818	538		4.7
V4P-1827	767		6.2
V4P-1835	934		7.9
V4P-1844	1128		9.3
V4P-1840	1253		9.9

V4P-25 Dimensions and Weight

Type	A	B	Weight(kg)
V4P-2506	296	1 1/2"	2.9
V4P-2512	433		4.1
V4P-2524	777		6.6
V4P-2540	1160		10.4
V4P-2544	1296		11.2

V4P-35 Dimensions and Weight

Type	A	B	Weight(kg)
V4P-3507	390	1 1/2"	3.7
V4P-3510	483		4.6
V4P-3514	607		5.7
V4P-3520	831		7.5
V4P-3527	1048		9.6
V4P-3534	1257		11.6
V4P-3536	1318		12.2
V4P-3549	1802		15.9

V4P-40 Dimensions and Weight

Type	A	B	Weight(kg)
V4P-4004	294	1 1/2"	2.8
V4P-4006	356		3.4
V4P-4008	418		4.0
V4P-4013	573		5.5
V4P-4017	697		6.6
V4P-4021	859		7.8
V4P-4023	921		8.4
V4P-4032	1238		11.0

V4P-55 Dimensions and Weight

Type	A	B	Weight(kg)
V4P-5510	532	1 1/2"	5.3
V4P-5510	693		6.7
V4P-5520	900		8.5
V4P-5518	1147		10.4
V4P-5522	1345		12.3
V4P-5524	1449		13.2
V4P-5532	1866		17

V4P-60 Dimensions and Weight

Type	A	B	Weight(kg)
V4P-6007	534	1 1/2"	5.3
V4P-6010	690		6.7
V4P-6014	989		8.6
V4P-6017	1092		10.1
V4P-6019	1195		11.0
V4P-6026	1559		14.3

V4P-80 Dimensions and Weight

Type	A	B	Weight(kg)
V4P-8008	676	1 1/2"	6.3
V4P-8011	880		8.1
V4P-8013	1013		9.3
V4P-8015	1149		10.5
V4P-8020	1489		13.5

V4P-05 Performance Curves Selection Chart

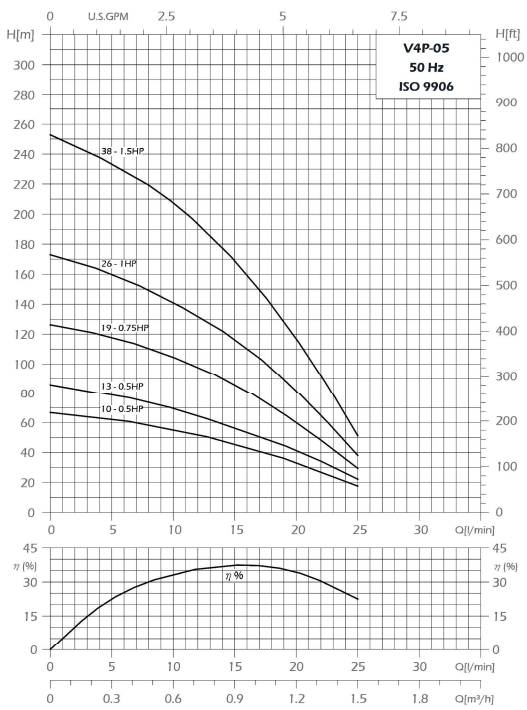

V4P-05 Selection Chart																
Type	Stage	Motor	L/MIN	0	5	10	15	20	25	30	35	40	45	50	Length	Weight
		HP	KW	M³/H	INCHES										mm	kg
V4P-0510	10	0.5	0.37	67	63	55	46	33	18						324	3.3
V4P-0513	13	0.5	0.37	86	78	70	56	42	23						377	3.7
V4P-0519	19	0.75	0.55	126	118	105	86	60	30						481	4.7
V4P-0526	26	1.0	0.75	173	160	141	117	81	39						642	5.8
V4P-0538	38	1.5	1.1	253	234	208	169	117	52						864	8.2

All technical information is subject to change without notice.

V4P-10 Performance Curves Selection Chart

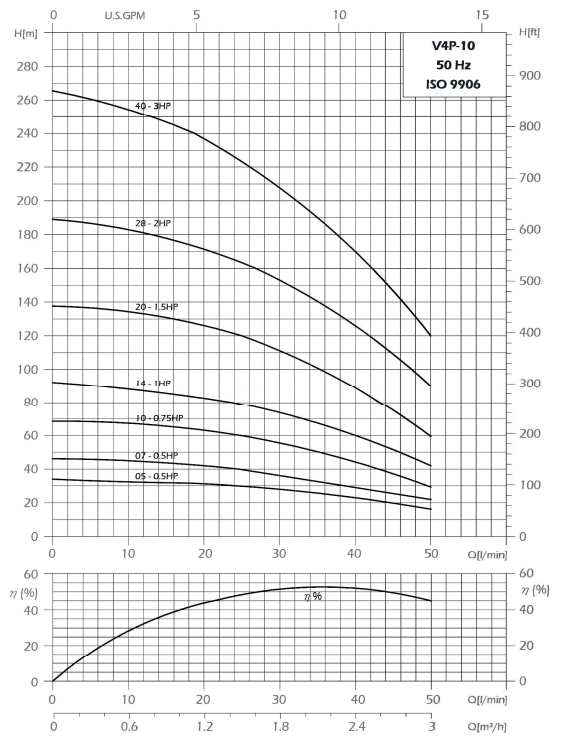

V4P-10 Selection Chart																		
Type	Stage	Motor	L/MIN	0	5	10	15	20	25	30	35	40	45	50	60	Length	Weight	
		HP	KW	M³/H	INCHES												mm	kg
V4P-1005	5	0.5	0.37	34												236	2.5	
V4P-1007	7	0.5	0.37	46			32	31	29	27	25	23	19	16		271	2.8	
V4P-1010	10	0.75	0.55	69			43	42	39	36	33	29	26	22		324	3.3	
V4P-1014	14	1	0.75	92			86	83	79	74	67	60	52	42		394	3.9	
V4P-1020	20	1.5	1.1	139			131	127	120	111	101	90	75	60		499	4.9	
V4P-1028	28	2	1.5	189			178	172	164	153	140	126	108	90		680	6.9	
V4P-1040	40	3	2.2	265			247	237	223	208	189	170	147	120		885	9.3	

V4P-13 Performance Curves Selection Chart

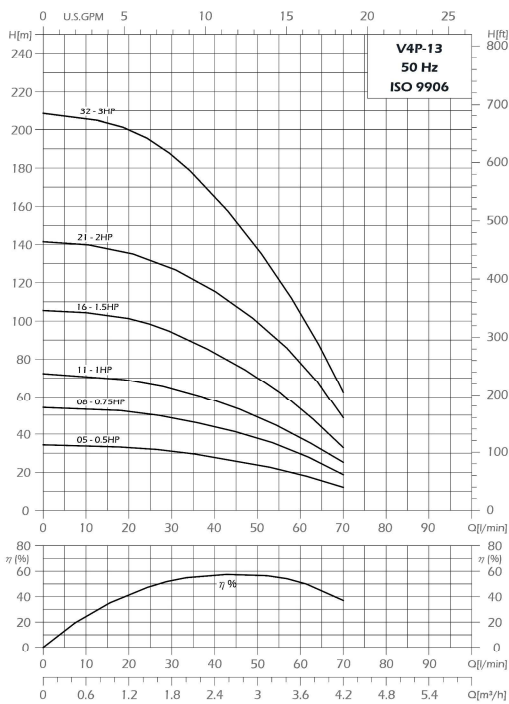

Type	Stage	Motor	L/MIN	0	15	20	25	30	35	40	45	50	60	70	Length	Weight
		HP KW	M³/H	0	0.9	1.2	1.5	1.8	2.1	2.4	2.7	3.0	3.6	4.2	mm	kg
V4P-1305	5	0.5 0.37	34		32	31	30	29	28	26	24	19	13	256	2.5	
V4P-1308	8	0.75 0.55	54		51	50	49	46	43	41	38	30	19	289	2.9	
V4P-1311	11	1.0 0.75	72		68	66	64	61	58	54	49	38	26	342	3.4	
V4P-1316	16	1.5 1.1	106		101	98	95	89	83	77	70	54	33	430	4.2	
V4P-1321	21	2.0 1.5	142		135	132	127	122	115	108	100	79	49	519	5.0	
V4P-1332	32	3.0 2.2	208		200	194	187	177	165	152	138	104	62	749	7.1	

All technical information is subject to change without notice.

V4P-18 Performance Curves Selection Chart

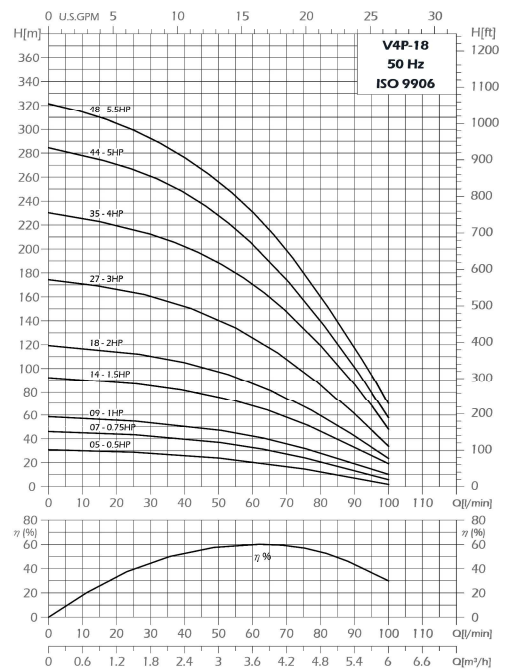

Type	Stage	Motor	L/MIN	0	20	25	30	35	40	45	50	60	70	80	90	100	Length	Weight
		HP KW	M³/H	0	1.2	1.5	1.8	2.1	2.4	2.7	3.0	3.6	4.2	4.8	5.4	6.0	mm	kg
V4P-1805	5	0.5 0.37	33		29	28	27	26	25	24	21	18	13	8	3	257	2.7	
V4P-1807	7	0.75 0.55	46		43	42	41	40	39	37	33	28	21	13	7	301	3.0	
V4P-1809	9	1.0 0.75	59		55	54	52	51	49	47	43	37	28	20	10	344	3.3	
V4P-1814	14	1.5 1.1	93		87	86	83	81	79	76	68	58	47	33	20	452	4.1	
V4P-1818	18	2.0 1.5	120		113	111	108	105	102	98	88	75	60	42	25	538	4.7	
V4P-1827	27	3.0 2.2	175		164	161	157	152	147	141	127	109	87	61	35	767	6.2	
V4P-1835	35	4.0 3.0	231		217	212	208	202	196	189	170	149	126	87	50	934	7.9	
V4P-1844	44	5.0 3.7	285		266	260	254	248	238	229	203	172	139	100	59	1128	9.3	
V4P-1848	48	5.5 4.0	322		299	292	285	276	267	258	231	199	166	118	70	1253	9.9	